

News Release

12/6/2007

To whom it may concern

Planex Communications Inc.
President/CEO Katsuaki Kubota
(JASDAQ code 6784)
Management Planning Division/GM Takumi Konuma
TEL: 03-5766-1333

Draft IEEE802.11n High Speed 300Mbps support wireless LAN router 「MZK-W04NU」 with 3x3dbi antenna , 1x USB port which support NAS, Printing , BT announced for launch

Planex Communications Inc. (President/CEO : Katsuaki Kubota, Headquarter : Tokyo Shibuya-ku, JASDAQ code 6784) announced the launch of Draft IEEE802.11n High Speed 300Mbps Wireless LAN router 「MZK-W04NU」 which support NAS by adding Hard Disk, printing server and BT will be available in the end of December at resellers all over Japan and PLANEX DIRECT(JP).

In addition, the sales forecast is included into this year's earning forecast.

※ MZK-W04NU will be launched to international market in February, 2008.

□□Main Feature□□

■ Support IEEE802.11n Draft2.0

It supports the next generation high speed wireless LAN protocol IEEE802.11n Draft2.0 which transfer maximum 300Mbps(theoretical figure) through put. By receiving with multiple antennas, it will provide stable connection for weak signal distanced place or dead spot place due to obstacles.

※In order to connect with Draft IEEE802.11n protocol, the connection device has to support Draft IEEE802.11n.

■ WPS Button (Easy wireless LAN set up function)



For first time user it supports WPS which provides one button push security set up for wireless LAN.

※Both main unit and client device have to support WPS.

【What is WPS?】

WPS is an abbreviation of 「Wi-Fi Protected Setup」 and a regulation for the easy connection of wireless LAN and security set up. A wireless LAN related industry organization 「Wi-Fi Affiliation」 fixes the specification and started accreditation from January 2007. There is a merit that the compatible device with WPS is easy to set up without complication like in the past.

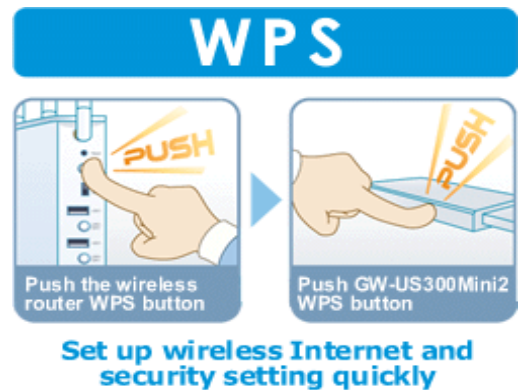

■ Robust for obstacles

It supports Draft11n 「MMO (Multiple Input Multiple Output)」 It has 3 antennas which will provide powerful sending and receiving data. Therefore, even under bad reception area due to obstructed obstacle to the signal it can achieve stable connection.

■ Advanced Security

The communication data will be encrypted by 64bit/128bit WEP or WPA(PSK-TKIP) 、 WPA2-PSK (AES) , it gives robust security an ease of mind for using wireless LAN.

■ One touch switch over from router to access point

It provides one touch switch over from router to access point, so that with or without modem's router, it will work with almost all of ISPs.

■ Inter-operate with existing wireless LAN client

It supports inter-operation with IEEE802.11b/g wireless protocol No new adaptor needed. Connecting both Draft IEEE802.11n PC and a IEEE802.11b/g PC.

●Wired part function

■ Support 10BASE-T /100BASE-TX

It has 1 WAN port and 4 LAN port. Both WAN and LAN support 10BASE-T /100BASE-TX.

●Others

■ BitTorrent function 

It enables a router to download contents without PC. Just set up download by any browser, it will download contents into USB connected hard disk even if the PC is turn off. It will allow users to download remotely if there is an access to browser.

■ iTunes server function

By saving music data in USB connected hard disk or connecting IPOD to a router, it support play back streaming direct to multiple PC. With this function, music file doesn't

need to save music on Hard drive. (Compatible file format is only FAT32)

■ **Home Media Server function(DLNAv1.0 compatible)**

It is compatible with DLNA regulation by which using home LAN network, enables to connect AV device, PC, Digital home electronics and operate in conjunction with them. It support inter-operates connection with increasing DLNA compatible devices.

■ **File Server**

It has two USB port. By connecting external hard disk to USB port, it can be used as NAS.



■ **Wi-Fi CERTIFIED」 certification acquisition**

It has 「Wi-Fi CERTIFIED」certificate which proves the performance expected from [Draft IEEE802.11n/g/bwireless] regulation set by Wi-Fi alliance organization up to certify the connection. It will give the peace of mind.

■ **Support RoHS**

Through the production to the scrap a product life cycle, this product supports 「RoHS」 which is to limit the usage of harmful substance such as lead, cadmium, liquid silver, hexavalent chrome, polybrominated biphenyl, Polybrominated diphenyl ether.

Product Specifications (These specs will be changed without notice. Please be forewarned.)

Product No.	MZK-W04NU
Wireless Part Specs	
Support Format	IEEE802.11b、IEEE802.11g、Draft IEEE802.11n
Number of channels	IEEE802.11b : 13 (1~13ch)
	IEEE802.11g : 13 (1~13ch)
	Draft IEEE 802.11n : 13 (1~13ch)
Frequency(main frequency)	IEEE802.11b : 2.4GHzzone (2,412~2,472MHz)
	IEEE802.11g : 2.4Ghz zone (2,412~2,472MHz)
	Draft IEEE802.11n : 2.4GHzzone (2,412~2,472MHz)
Transfer Speed	IEEE802.11b : 11、5.5、2、1Mbps auto recognition
	IEEE802.11g : 54、48、36、24、18、12、9、6Mbps auto recognition
	Draft IEEE 802.11n : Max. 300Mbps (MIMO mode)

Transfer Format	IEEE802.11b : direct diffusion spectrum diffusion (DSSS)
	IEEE802.11g : orthogonal wave frequency divide multiple module (OFDM)
	Draft IEEE 802.11n : orthogonal wave frequency divide multiple module (OFDM)
Antenna	dipole antenna x 3 (Sendx2 /Receivex3 MIMO)
Access Format	Infrastructure Mode
Security	WEP (64/128bit)
	WPA/WPA2 (cipher system : TKIP/AES 、 authentic method : PSK/IEEE802.1X)
	External RADIUS Support
	SSID notification (Valid/Invalid)
	MAC Address Filtering (Authorize/Refuse)
WDS	WDS Bridge 、 WDS Repeater
Auto Wireless Setup function	WPS
Wired Part Specs (WAN side)	
Support Format	IEEE802.3 (10BASE-T) 、 IEEE802.3u (100BASE-TX)
Interface	RJ-45portx 5 (WANx1 、 LANx4 、 Auto MDI/MDI-X support)
Connector configuration	RJ-45connector
Transfer Speed	10/100Mbps (Auto Negotiation)
Network Cable	10BASE-T : Category 3 UTP cable up
	100BASE-TX : Category 5 UTP Cable up
Router function	
Support WAN line	FTTH 、 ADSL 、 VDSL 、 CATV
WAN Set up	IP Address Auto gain (DHCP client)
	Fixed IP address (Manual Setup)
	PPPoE client setup
	PPPoE multi session (Max. 2 sessions)
	Multiple fixed IP set up (Unnumbered set up)
	MTU Set up
LAN Set up	Fixed IP address (Manual set up)
	DHCP Server (Valid/Invalid)
Security	IP Address filtering (Allow/Refuse)
Address Conversion	NAPT (IP masquerading)
Local server function	Port forward (Virtual DMZ)
UPnP	UPnP Forum Internet Gateway Device v1.0 compliance
Dynamic DNS	CyberGate - DDNS - 、 DynDNS

Hardware specs	
Switches	WPS Button · Reset button · AP/Router Switch over
LED	POWER · AP · Router · WAN×1 · LAN×4 · USB · WLAN · STATUS
Power	DC5V
Outside Dimension	34 (W) ×191 (H) ×161 (D) mm (Except antenna part)
Operation Environment	Temp. : 0~40°C
	Humid : 10~90% (no condensation)
USB specs	
Number of the port	USB2.0×1 (Type A connector)
USB Functions	File server function
	Bit TorrentClient function
	iTunes Server Function
Others	
DLNA function	DLNA1.0
Log function	System log
NTP function	Time zone setup. NTP server registration x 2
Administrative function	Remote management
Support OS	Windows Vista/XP/2000/Me/98SE · MacOS X+ (Japanese version)
Various Setting	WEB browser
Warranty	1 year

※IEEE802.1X requires external RADIUS server.

※There might not be able to display correctly with some browsers at web browser setup.

※In order to use WPA/WPA2, the connected wireless devices have to support WPA or WPA2.

※In order to use WPS, the connected wireless devices have to support WPS.

※The numeric number shown here is a theoretical maximum number and not a actual number.

※WDS bridge function is supported only identical devices.

◇Draft2.0/g/b 11n support high speed 300Mbps wireless LAN router with USB port



Product No. : MZK-W04NU (JAN code 4941250162208)

Price : 14,800 yen (Includes sales tax)

※The price is at the launch and will be changed without notice. Please be forewarned.